

# 34a-18 Manual Transmission

## Transmission, Removing and Installing (All Wheel Drive)

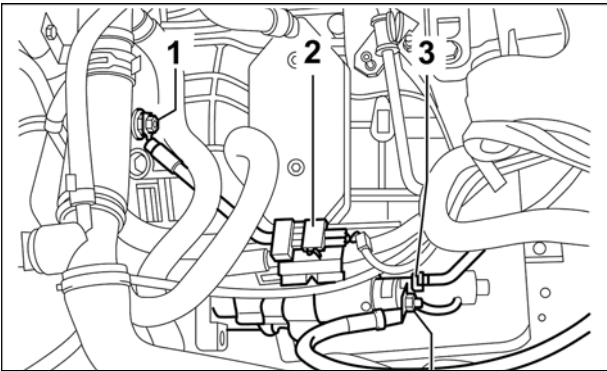

➤ Remove ground strap eyelet (1) from engine/transmission mounting bolt.

– Disconnect harness connector (3) from starter. Heavy gauge positive wire (4) remains connected.

– Disconnect harness connector (2) and detach from bracket.

– Detach wires from bracket at starter and lay to the side.

– Remove bracket at starter.

– Remove upper starter mounting bolt.

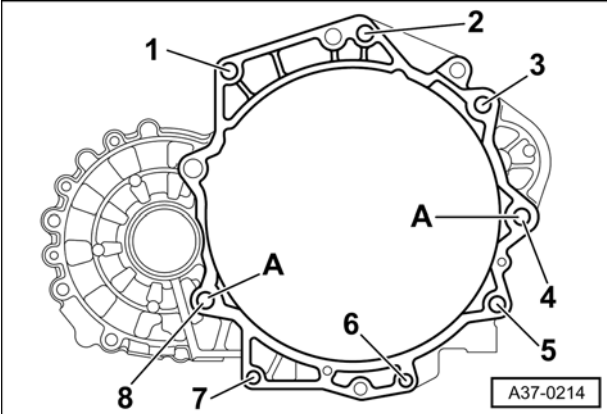

➤ Remove engine/transmission connecting bolts accessible from above.

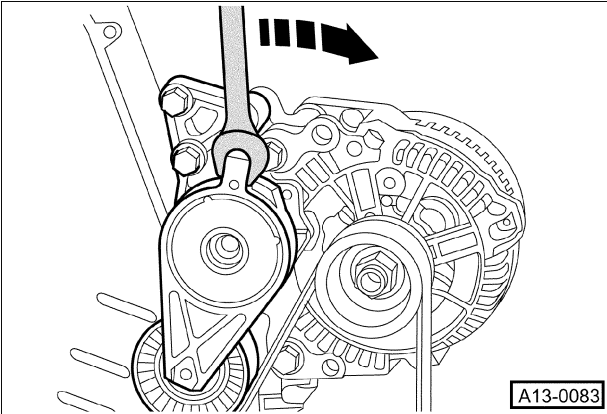

➤ Mark running direction of ribbed belt. Using a 15 mm open end wrench, release tensioner (**dashed arrow**) and remove ribbed belt.

– Raise vehicle and support safely. See **03 Maintenance**.

### **WARNING**—

- Make sure vehicle is stable and well supported at all times. Use a professional automotive lift or jack stands designed for the purpose. A floor jack is not adequate support.

– Remove both front wheels.

– Remove lower sound absorber panels. See **03 Maintenance**.

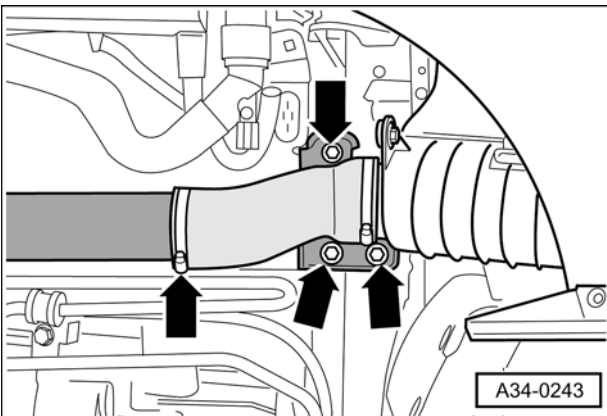

➤ Remove bolts and clamp (**arrows**) and remove intercooler connecting duct.

## Transmission, Removing and Installing (All Wheel Drive)

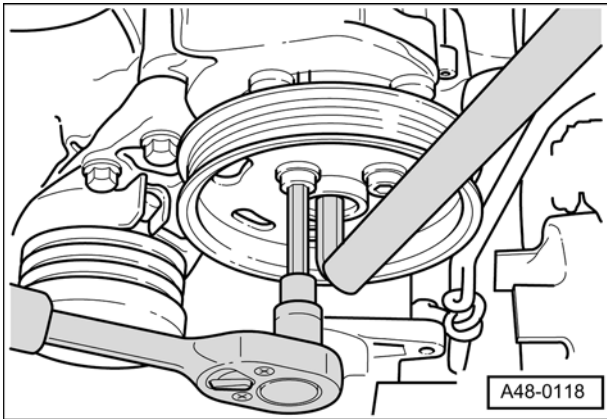

- ◀ Counterhold power steering pump shaft with a hex key and remove pulley.

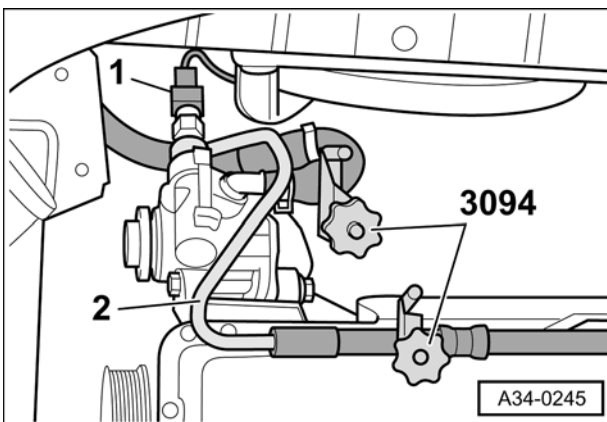

- ◀ Clamp supply and pressure lines at power steering pump lines with **3094** or equivalent clamps with 25 mm (1 in) diameter line capacity.
  - Disconnect harness connector from power steering pressure switch (1).
  - Disconnect and remove pressure line (2) from power steering pump.
  - Disconnect and remove supply line from power steering pump.

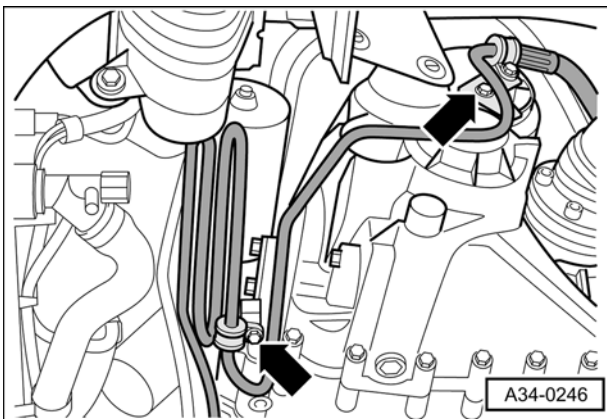

- ◀ Remove power steering line clamp and bracket bolts (**arrows**). Remove clamps, brackets and additional support brackets (if installed).
  - Remove lower starter mounting bolts and starter. See **27 Battery, Alternator, Starter**

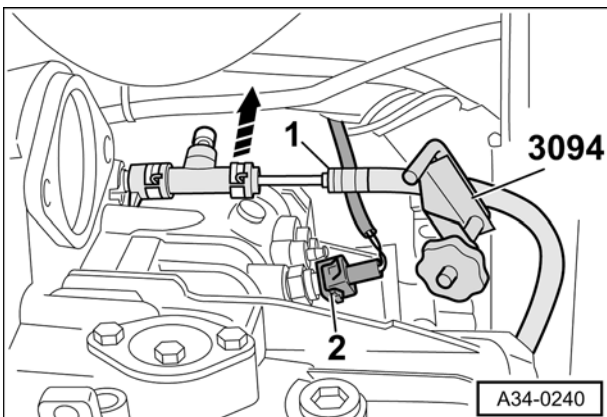

- ◀ Clamp clutch slave cylinder line with **3094** or equivalent clamp with 25 mm (1 in) diameter line capacity.
  - Pull retainer clip upward (**dashed arrow**) and pull pressure line (1) out of clutch slave cylinder connection.

**NOTE** —

- Do not depress clutch pedal while line is disconnected.

- Disconnect harness connector for back up light switch (2).

# 34a-20 Manual Transmission

## Transmission, Removing and Installing (All Wheel Drive)

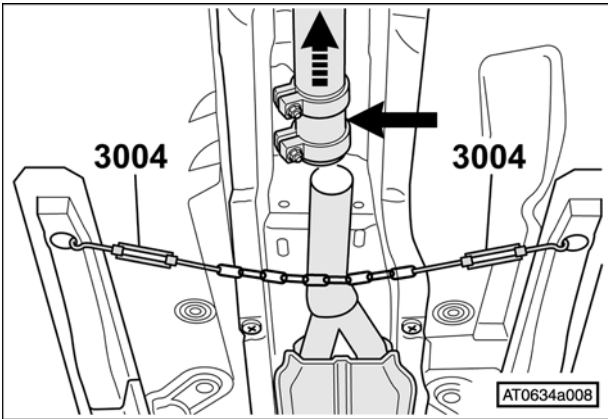

Loosen double clamp on exhaust system (**arrow**) and slide clamp to the rear of vehicle (**dashed arrow**) to disconnect.

- Support front section of exhaust system using turnbuckles and chains (**3004** and chain shown).

**NOTE** —

- To prevent damage, do not allow flex joint for exhaust system to bend more than 10°.

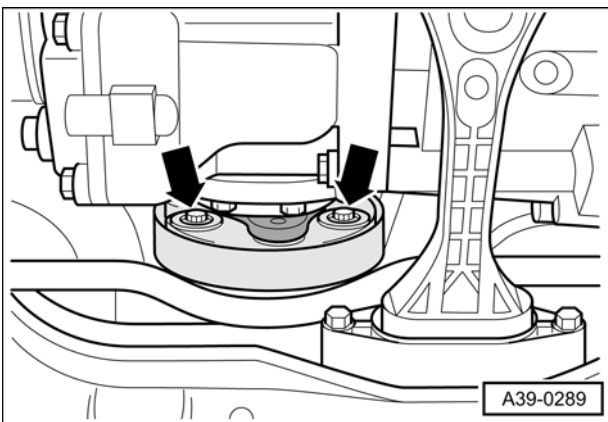

Mark position of drive shaft at flexible disc coupling at bevel gear transfer case.

- Unbolt driveshaft from flexible disc coupling at bevel gear transfer case (**arrows**).

**NOTE** —

- To remove bolts, counterhold driveshaft at triangular drive flange using a lever.

- Push driveshaft horizontally as far to the rear as possible.

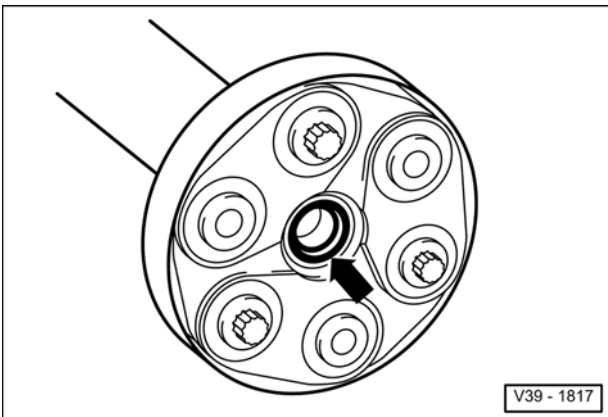

When working around driveshaft, be sure not to damage seals (**arrow**) in flange of drive axle, especially when removing and installing. If seals are damaged, driveshaft must be replaced.

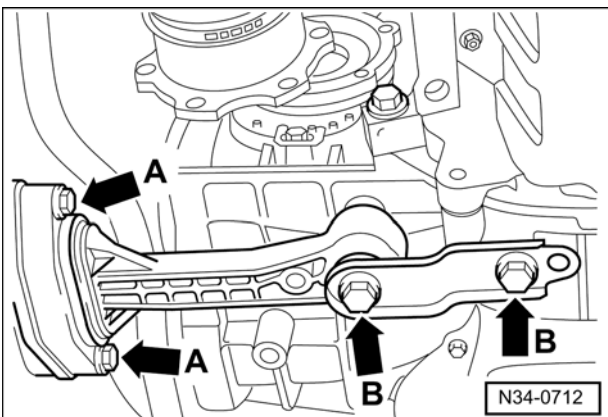

Remove pendulum support. First remove bolts (**A**) and then bolts (**B**).

**NOTE** —

- After removing bolts (**A**), engine/transmission assembly will move slightly forward.

## Transmission, Removing and Installing (All Wheel Drive)

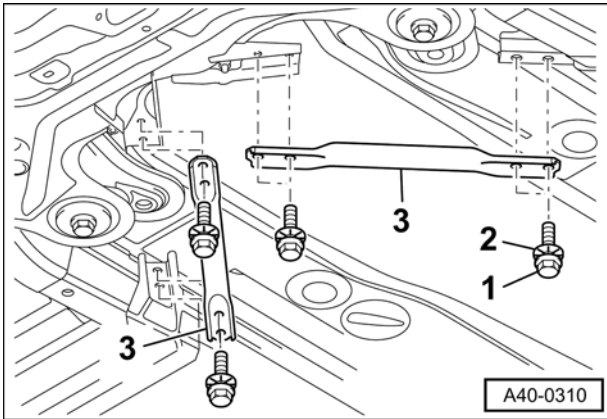

- Where applicable, remove 8 bolts (1) with locking washers (2) and remove subframe diagonal support members (3).

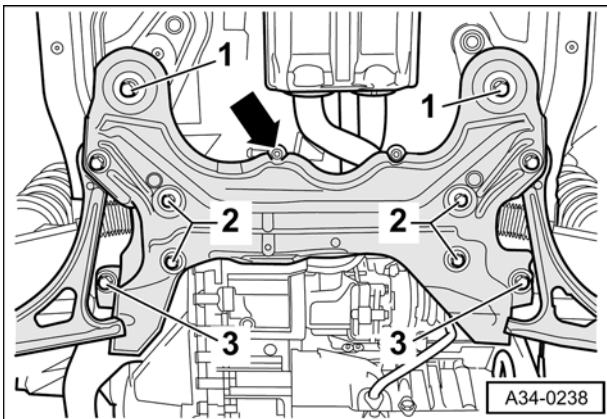

- Remove front exhaust system bracket from subframe (**arrow**) where installed.

- Remove steering gear bolts (2).
- Carefully pry off steering gear from subframe.
- Place engine/transmission jack under subframe for support.
- Remove subframe mounting bolts (1 and 3).
- Carefully lower subframe and let it hang on ball joints and connecting links.
- Tie steering gear up and out of the way using wire or tie wraps.

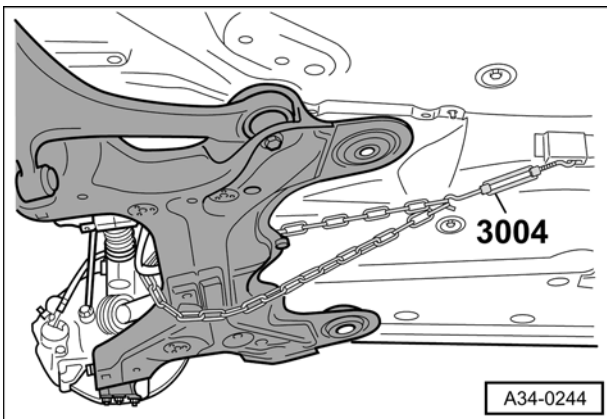

- Remove drive axles from transmission drive flanges and lay behind on subframe taking care to avoid damage to subframe coatings and constant velocity joint boots.

- Tie subframe toward the rear using a chain with a turnbuckle (3004) arrangement. Remove plug from underbody as needed and hook chain into opening in vehicle floor

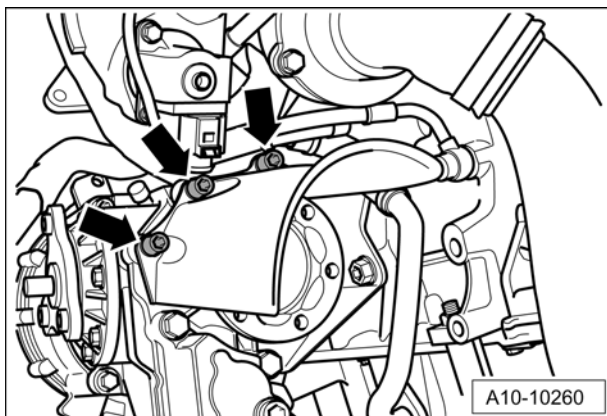

- Unbolt (**arrows**) and remove heatshield for right side drive axle from bevel gear transfer case.